

# DBL 28

## FIRE & SAFETY EQUIPMENT PLAN

- Smoke Alarm**
- Defibrillator**
- Co2 Extinguisher**
- Dry Chem Extinguisher**
- 100# B-V Dry Chemical Extinguisher**
- Life Ring & Life Ring w/Light**
- Remote Vent Shut Off**
- Pump Engine Shutdown**
- Life Jacket**
- First Aid Kit**
- SCBA**
- Flashlight**
- Emerg Lights**
- Fire Locker**
- Firemen's Outfit**
- Fire Axe**

Survival Suit

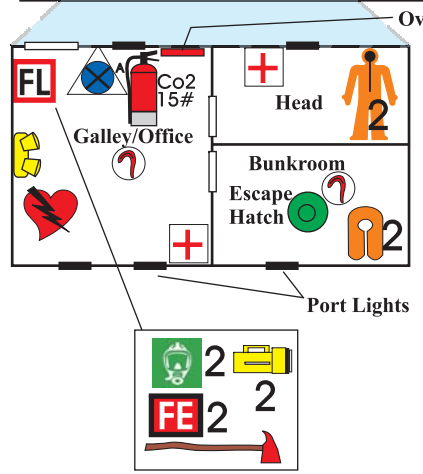
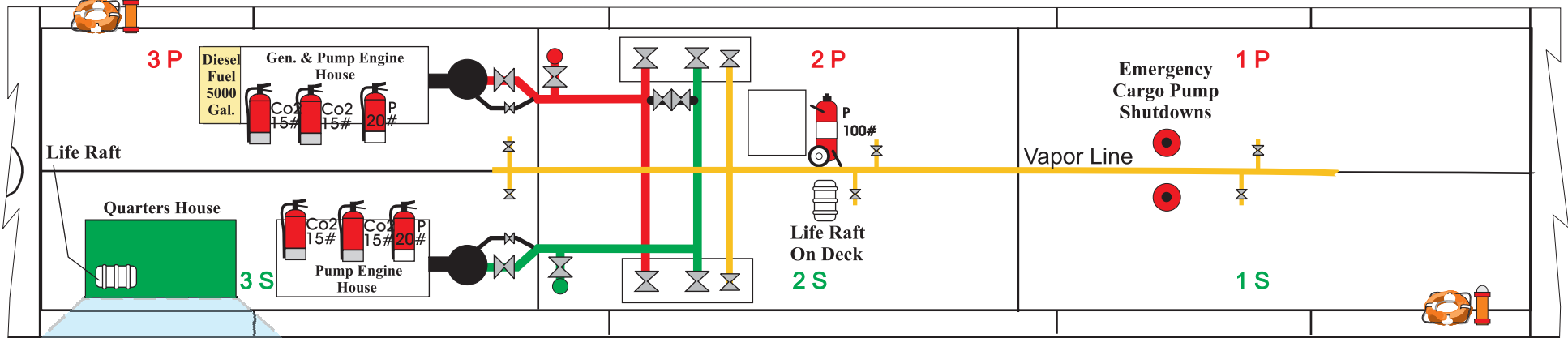

**K-SEA**  
K-Sea Transportation Inc.

297'6" X 54' X 13'  
 Double Hull Barge  
 Year Built : 2005  
 Bollinger Hull 496  
 Official No. 1178813  
 Gross Tons: 1754  
 Pumps - 2 Deepwells

CAPACITY - 28,000 BARRELS @100%

1 PORT - 4,850.4	1 STARB - 4,850.4
2 PORT - 4,486.2	2 STARB - 4,486.2
3 PORT - 4,697.1	3 STARB - 4,697.1

Loaded Draft 11.9'