

FIRE PLAN & EQUIPMENT LOCATION

Liz Vinik

110' X 28' X 13' 7" TWIN SCREW TUG
 BUILT BY: JAKOBSON SHIP YARD, INC.
 OFFICIAL No. 287444 - HULL NO. 406
 H.P. 3010

FUEL OIL36,580 GALLONS
 LUBE OIL440 GALLONS
 BALLAST.....50,652 GALLONS
 POTABLE WATER...2,500 GALLONS

- Smoke Alarm
- Heat Sensor
- Co2 Pulls
- Fire Station & Hydrant
- Fire Axe
- Ext. Station #
- 15# Extinguisher
- 10# Extinguisher
- 5# Extinguisher
- Fire Pump
- Defibrillator
- Fuel Shut-Off

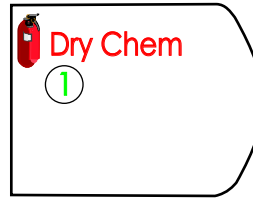

Pilothouse

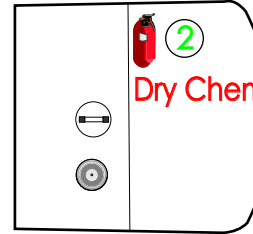

Third Deck

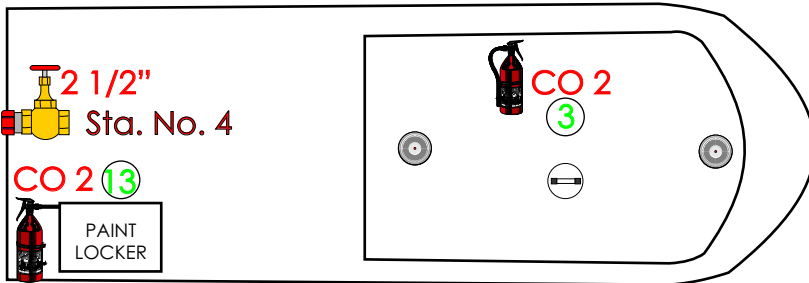

Boat Deck

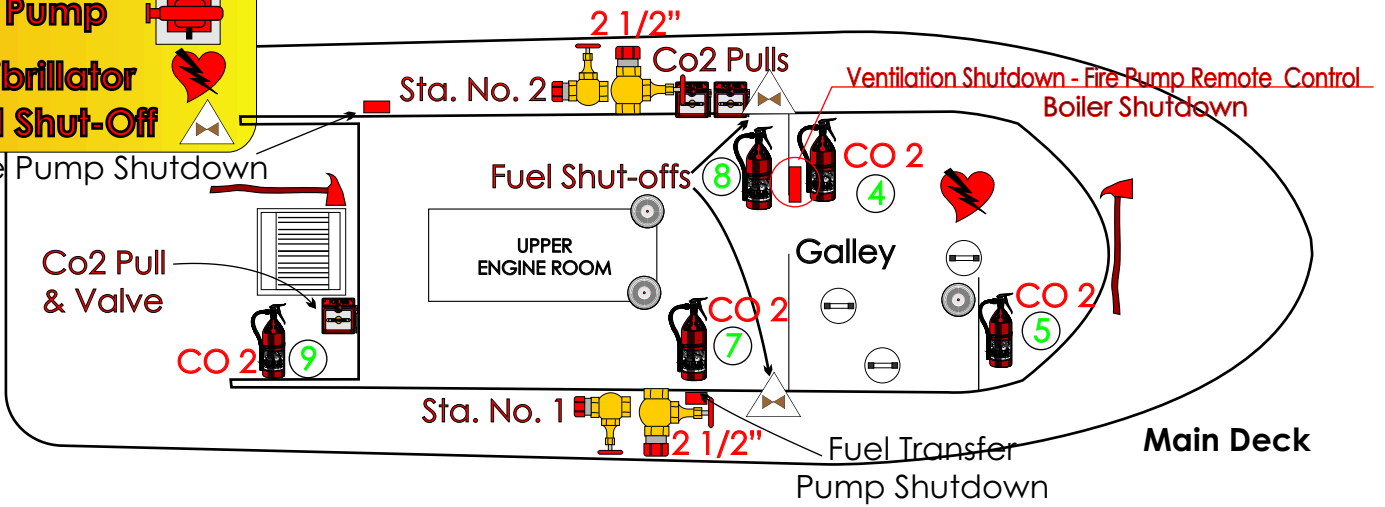

Main Deck

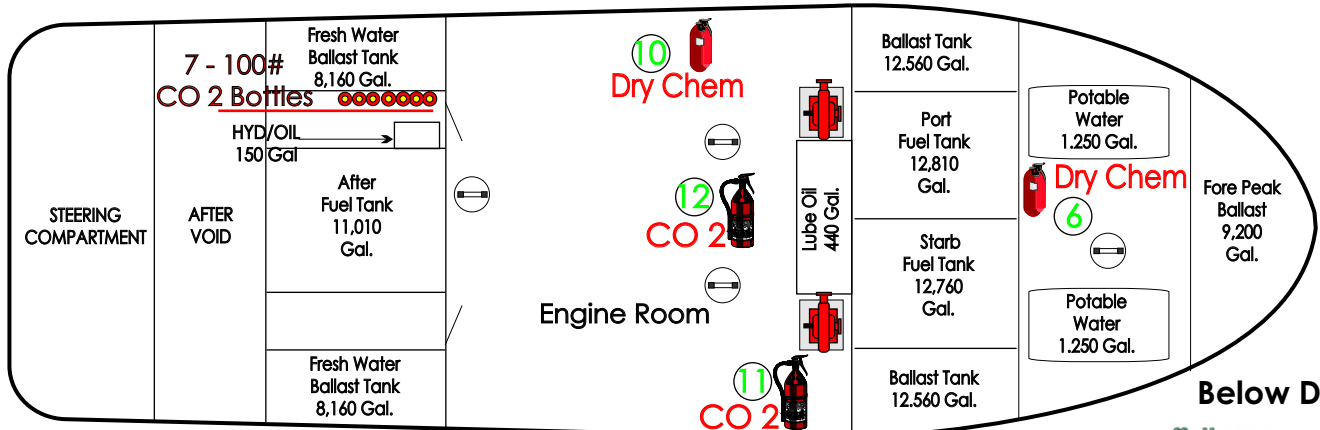

Below Deck